

UMA

—By Lledo & Campos—



■ **DESCRIPTION**

Seat and back have an aluminium internal frame covered by 90-100 m³ density flexible **PUR injected foam**. This foam is additionally covered by a foam fabric made of 3mm PU foam (22kg/m³ density) + Fabric.

Four models of arms: with arms in polypropylene (PP) in grey or black, lined writing tablet, metal arms or in white phenolic 13 mm thick. **Steel Tubular Almond 28 x 20** and 1,5 mm thick **aluminized, chrome or black finish**. Polypropylene (P.P) in grey or black.

■ **BACK AND SEAT**

(SEE FINISHES AND FABRIC CARD LAST PAGE)

■ **ARMS OPTIONS**



Arm lining polypropylene (PP) + 10% F.V. Finished in black or grey



Upholstered arm with internal structure (20 x 6 mm + calibration plate Ø 8 mm) injected foam coated steel



Metal arm coated polypropylene (PP) (gauge steel plate 25 x 7 mm)



Optional writing tablet, compact laminate 13 mm. It could be fixed to the right or left hand side

■ **ACCESSORIES**



Optional Hook on basket Ø 5 mm thickness with supports Ø 7 mm thickness. **Aluminum finish**



Linking device of plastic

■ **SIZES**

Total height: 870 mm **Seat Height:** 440 mm
Total width: 520 mm **Seat Width:** 450 mm
Total depth: 530 mm **Seat Depth:** 430 mm

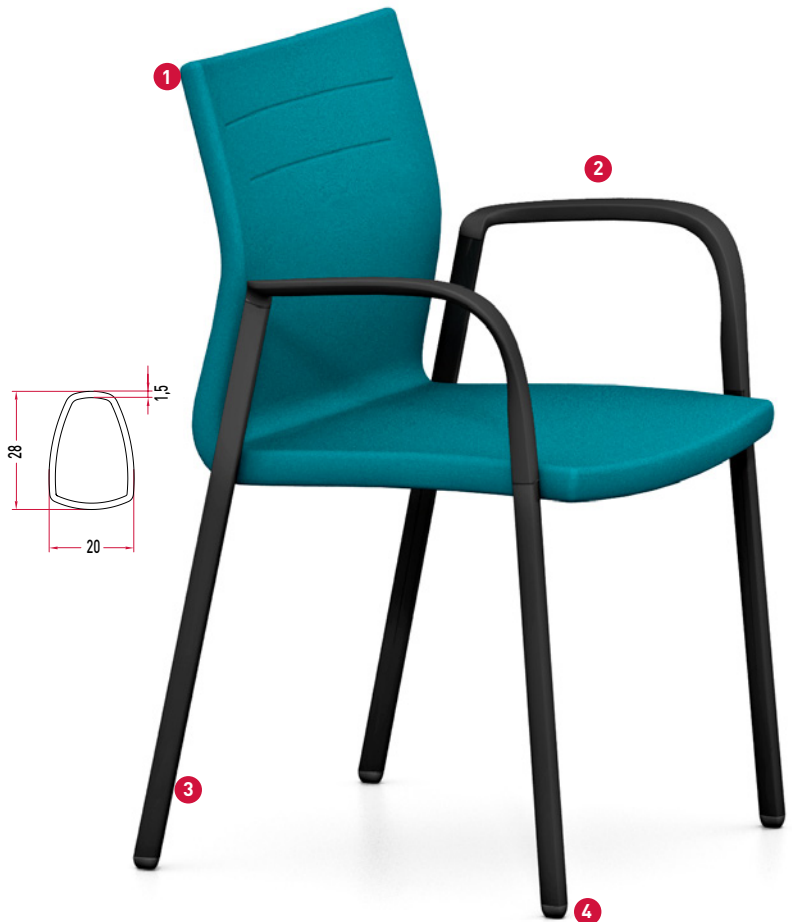

- ① PU flexible de 100-11⁰ kg/m³ back and seat
- ② Different arm choices (**check Arms**)
- ③ Steel Tubular Almond (**aluminized, chrome or black finish**)
- ④ Anti-skid polypropylene (**P.P**) 3 mm thickness black or dark grey finish

■ **SIZES**

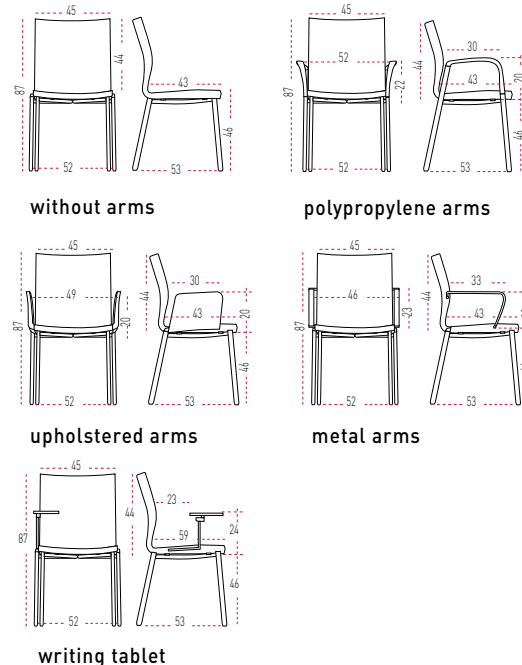

■ **DESCRIPTION**

Seat and back have an aluminium internal frame covered by 90-100 m³ density flexible **PUR injected foam**. This foam is additionally covered by a foam fabric made of 3mm PU foam (22kg/m³ density) + Fabric. The back of the chair is 30mm thick and seat is 40mm thick. Available with or without arms. Upholstered arms with internal aluminium frame covered by injected foam. **Beech conical wooden legs**. PP glides with black anti-slip filter.

■ **BACK AND SEAT**

(SEE FINISHES AND FABRIC CARD LAST PAGE)

■ **ARMS OPTIONS**



Upholstered arm with internal structure [20 x 6 mm + calibration plate Ø 8 mm] injected foam coated steel

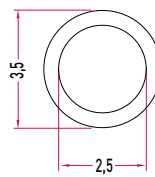

- ① PU flexible de 90 - 100 kg/m³ back and seat
- ② Model without arms or with upholstered arms
- ③ Conical wooden leg. Beech finishing
- ④ PP glides in black with anti-slip filter.
- ⑤ The upholstery incorporates hot sealed markings, which provides uniqueness *(Only on Melange fabrics)*

■ **SIZES**

Total height: 870 mm
Total width: 520 mm
Total depth: 530 mm

Seat Height: 440 mm
Seat Width: 450 mm
Seat Depth: 430 mm

■ **SIZES**

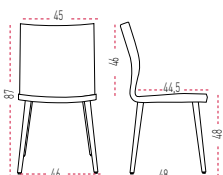

without arms

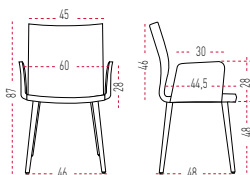

upholstered arms

■ DESCRIPTION

Seat and back have an aluminium internal frame covered by 90-100 m³ density flexible **PUR injected foam**. This foam is additionally covered by a foam fabric made of 3mm PU foam (22kg/m³ density) + Fabric.

Three models of arms with arms in polypropylene (PP) in gray or black, upholstery or metal.

Structure Base in **polished aluminum or black polyamide** - Ø 67,5 cm with rolling wheels with Teflon silent. Seat height adjustment by a gas pump.

■ BACK AND SEAT

(SEE FINISHES AND FABRIC CARD LAST PAGE)

■ ARMS OPTIONS



Arm lining polypropylene (PP) + 10% F.V. Finished in black or grey



Upholstered arm with internal structure (20 x 6 mm + calibration plate Ø 8 mm) injected foam coated steel



Metal arm coated polypropylene (PP) (gauge steel plate 25 x 7 mm)

■ BASE AND CASTORS



Polished aluminum - Ø 67,5 cm
Black soft castors - Ø 60 mm



Black polyamide - Ø 67,5 cm
Black soft castors - Ø 60 mm

■ SIZES

Total height: from 870 to 930 mm **Seat Height:** 440 mm
Total width: 675 mm **Seat Width:** 450 mm
Total depth: 675 mm **Seat Depth:** 430 mm



- ① PU flexible de 90-100kg/m³ back and seat
- ② Different arm choices (**check Arms**)
- ③ Gas lift
- ④ Base in **polished aluminum or black polyamide** - Ø 67,5 cm
- ⑤ Anti-skid castors, soft band, Ø 60 mm

■ SIZES

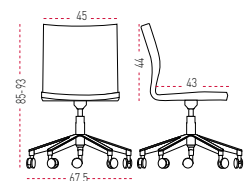

without arms

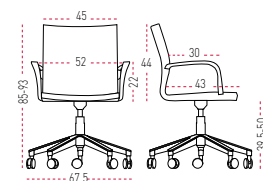

polypropylene arms

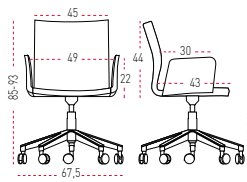

upholstered arms

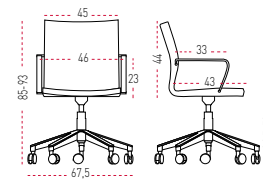

metal arms

■ DESCRIPTION

Seat and back have an aluminium internal frame covered by 90-100 m³ density flexible **PUR injected foam**. This foam is additionally covered by a foam fabric made of 3mm PU foam (22kg/m³ density) + Fabric.

Two models of arms, upholstered or metal arms.

Swivel base structure 67,5 cm in diameter

Polished aluminum with stoppers Polypropylene (PP) black caps.



■ BACK AND SEAT

(SEE FINISHES AND FABRIC CARD LAST PAGE)

■ ARMS OPTIONS



Upholstered arm with internal structure (20 x 6 mm + calibration plate Ø 8 mm) injected foam coated steel



Metal arm coated polypropylene (PP) (gauge steel plate 25 x 7 mm)

■ BASE



Swivel polished aluminum base - Ø 67,5 cm
Polypropylene (PP) black caps

- ① PU flexible de 100-11⁰ kg/m³ back and seat
- ② Different arm choices (check Arms)
- ③ Self-return system
- ④ Swivel base in **polished aluminum** - Ø 67,5 cm
- ⑤ Polypropylene (PP) black finish

■ SIZES

Total height: 880 mm

Total width: 675 mm

Total depth: 675 mm

Seat Height: 440 mm

Seat Width: 450 mm

Seat Depth: 430 mm

■ SIZES

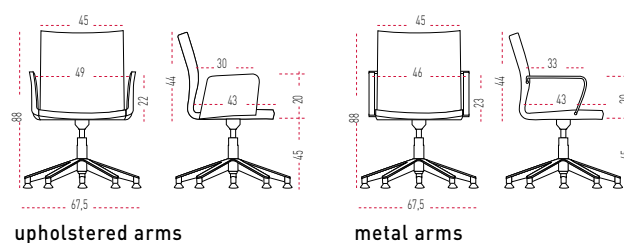

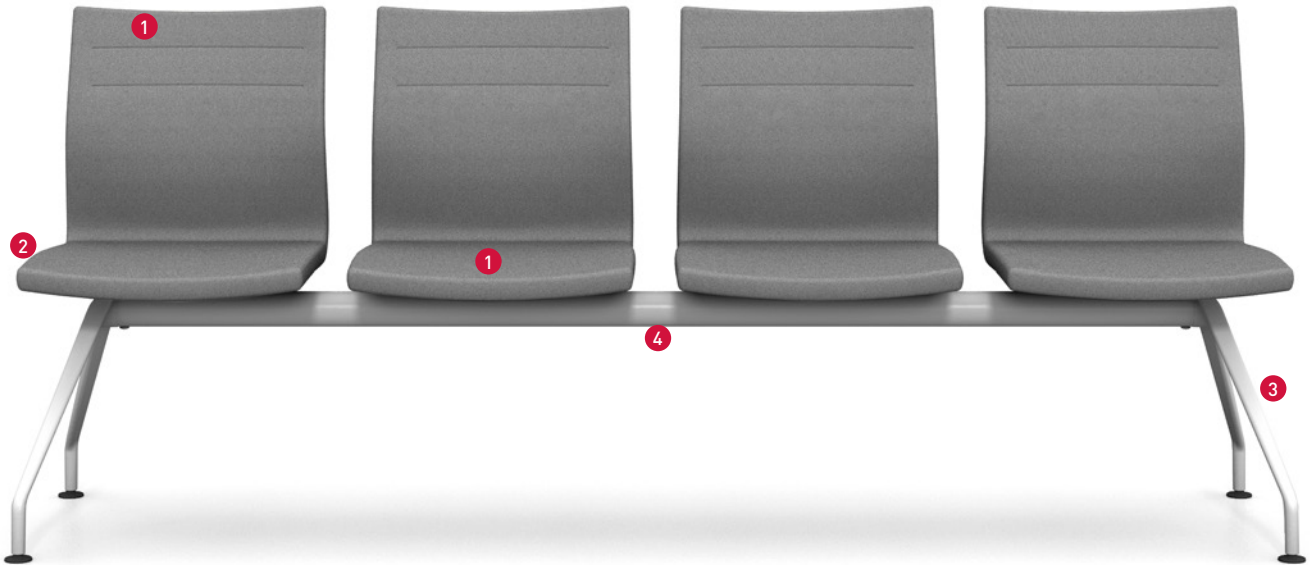

■ DESCRIPTION

- ① **Seat and back** have an aluminium internal frame covered by 90-100 m³ density flexible **PUR injected foam**. This foam is additionally covered by a foam fabric made of 3mm PU foam (22kg/m³ density) + Fabric.
- ② Model with aluminized finish metal **arms** or without **arms**
- ③ **Leg** in moulded injected aluminium with tips polypropylene (PP) of 3 mm thick black finish
- ④ **Lower** structural beam steel tube Ø60 of round section and thickness 3 mm
- ⑤ Melamine side **Table** of 19 mm optional and a variety of combinations, in white, aluminized, elm and wenge

■ SIZES

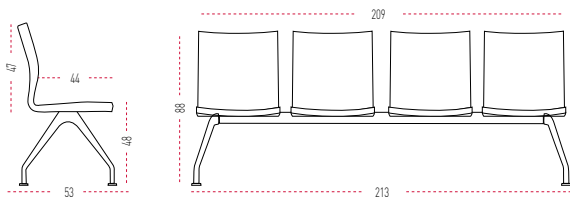

2, 3 or 4 seats

■ SIZES

- Total height: from 990 to 2070 mm
- Total width: from 860 mm
- Total depth: 400 mm

■ BACK AND SEAT

(SEE FINISHES AND FABRIC CARD LAST PAGE)

■ ARMS OPTIONS

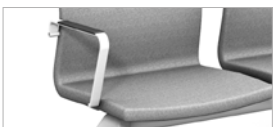

metal arm coated polypropylene (PP)
(gauge steel plate 25 x 7 mm)



melamine side table of 19 mm thick



MATERIALS

Maximum use of materials to eliminate and minimize scraps. Use of recyclable and recycled materials in those components that do not affect the functionality and durability.

10,41%
RECYCLED
MATERIALS



PRODUCTION

Maximum optimization of energy use. Minimal environmental impact. Last generation technological systems. Zero discharge of wastewater. No VOC coatings. Processes free of heavy metals, phosphates, OC and COD.

100%
RECYCLABLE
ALUMINIUM, STEEL
& WOOD



TRANSPORT

Detachable systems. Volumes that facilitate the optimization of space. Maximum reduction of energy consumption by transport.

100%
RECYCLABLE
PACKAGE AND THINNER
FREE



USE

Quality and warranty. Long lasting. Replacements available.

EASY
TO CLEAN
AND MAINTAIN



DISPOSAL

Waste reduction. Supplier-manufacturer packaging reuse system. Components are easy to be separated. Inks in packaging are water-based, without solvents.

78,55%
RECYCLABLE
MATERIALS

■ **CERTIFICATES AND REFERENCES**

The different programmes get points in different environmental categories to get the LEED certificate (sustainability, material and resources, water, energy and atmosphere, inner environment quality, innovation and design).



■ **STANDARDS**

UMA has passed tests done in our technical department as well as the tests done in **AIDIMA** the Technological Institute for furniture. The tests correspond to:

Office visitor chair. Standard Application

- **UNE-EN 16139:13.** Furniture. Resistance, long lasting, security. Requirements for non domestic use seating.

■ 4 LEGGED CHAIR WITH WRITING TABLET

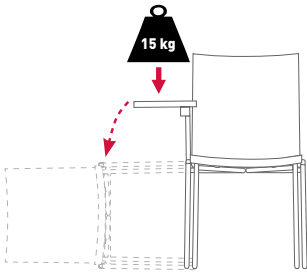

With weight more than 15 kg.
Without a seated user, the chair overturns.

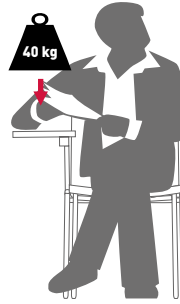

With a seated user, maximum
 resistance of writing tablet 40 kg.

FABRIC

■ BACK AND SEAT

GROUP T



GROUP C



GROUP N



GROUP M - MELANGE

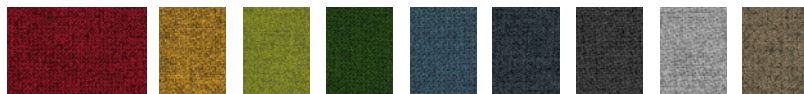

GROUP M - STEP

